

980/1550nm Fused Type PM WDM Coupler (PMWDMC)

Features

Low Insertion Loss
High Isolation & High ER
Telcordia GR-1221 Compliant
Both Axis Working

Application

PMF Amplifier
Testing Equipment
Fiber Laser
Monitoring in Coherent System



Specifications

Parameters	Unit	980/1550	
Center Wavelength ^[1]	nm	980	1550
Operating Wavelength Bandwidth	nm	±10	±15
Max Insertion Loss (IL) ^[2]	dB	0.7	0.7
Min Isolation (IS) ^[3]	dB	20	20
Polarization Extinction Ratio (PER)	dB	18	18
Fiber Type	-	PM980, PM1550	PM1550
Fiber Type at Com Port	-	PM1550	
Return Loss (RL) ^[4]	dB	≥50	
Cross Talk (CR) ^[5]	dB	≥50	
Max Power Handling CW ^[6]	W	1W (with connector), 4W (spliced)	
Operating Temperature	°C	-40 ~ +85	
Storage Temperature	°C	-40 ~ +85	

^[1] Center Wavelength can be customized.

^[2] Test at room temperature without connectors. With connectors, IL+0.3dB, PER-2dB, RL-5dB.

^[3] Test at center wavelength.

^[4] When test RL, coil all other port fibers 3-5 turns around a 10-30mm diameter loop, this prevents back reflections into test port, which would significantly lower RL.

^[5] $CR = 10 * \log_{10} (P_{port \lambda 1} / P_{port \lambda 2})$, P=power in mW, test wavelength can be either wavelength of the two,

^[6] Max power is for total power of longer wavelength+shorter wavelength. Higher power available on request.

Typical Spectrum

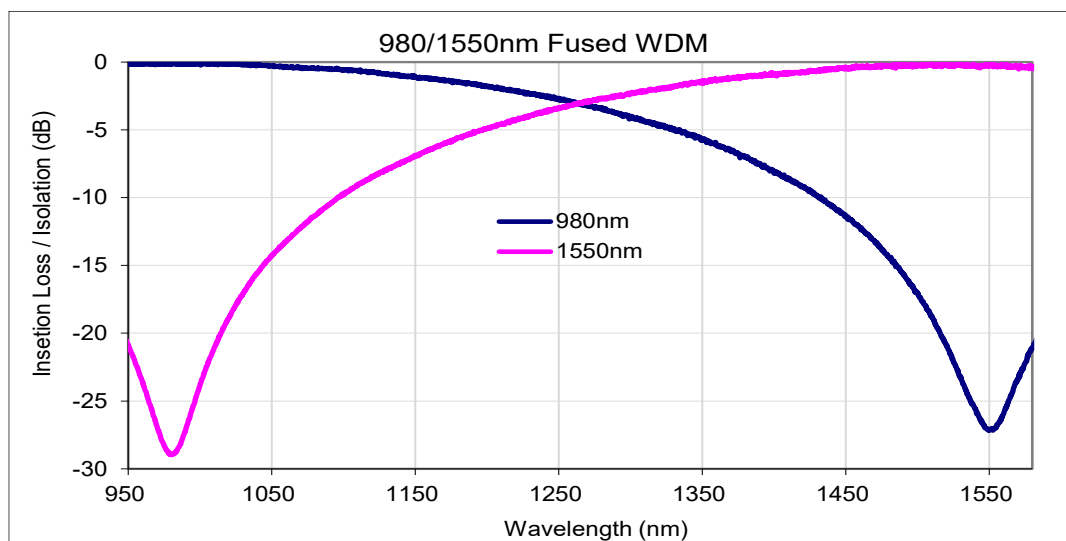

Package Information

Port Configuration	1x2 or 2x2		
Fiber Length	1m, others on request		
Pigtail Type	250μm Bare Fiber	900μm Loose Tube	2mm/3mm Loose Cable
Dimensions(mm)	φ3x54, 5x5x50	φ3x54	90x16x9
Approx Weight (g)	30	45	60

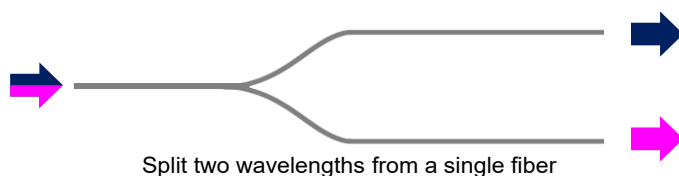
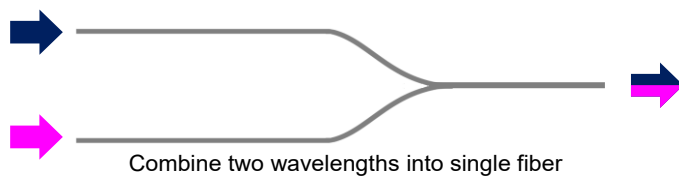
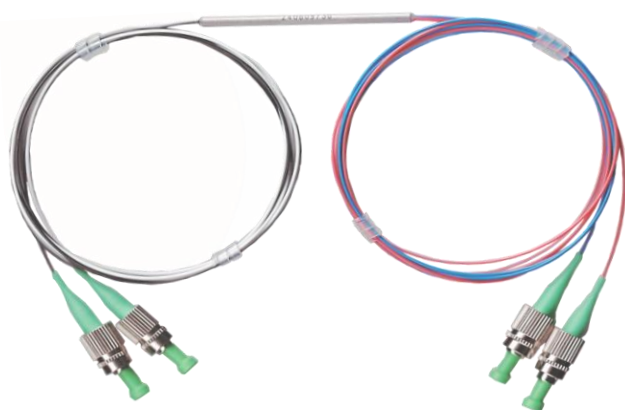
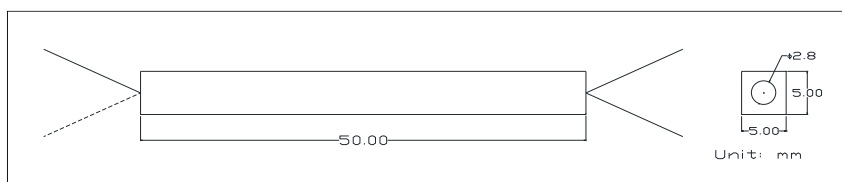
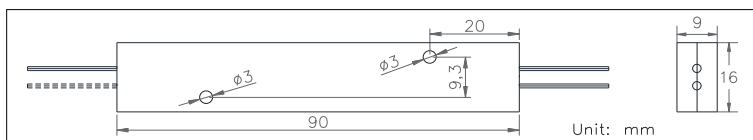
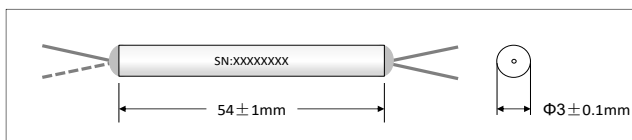

Bidirectional

Ordering Information

PMWDMC- ①①①-②②②②②②②②②-③③③-④④④-⑤-⑥⑥-⑦⑦⑦⑦⑦

①	Port Type	1x2; 2x2;
②	Wavelength	980/1550;
③	Pigtail Type	250=250μm Fiber; 900=900μm Loose Tube; 2000=2mm Loose Cable; 3000=3mm Loose Cable;
④	Fiber Type @ 980 Port	P98=P980 Fiber; P15=P1550 Fiber;
⑤	Fiber Length	1=1m; XX=other;
⑥	Connector	NE=None; FA=FC/APC; FC=FC/UPC; SA=SC/APC; SC=SC/UPC; LC=LC/UPC; XX=Others;
⑦	Package	3x54; 90x16x9; 5x5x50;